

Rittal – The System.

Faster – better – everywhere.

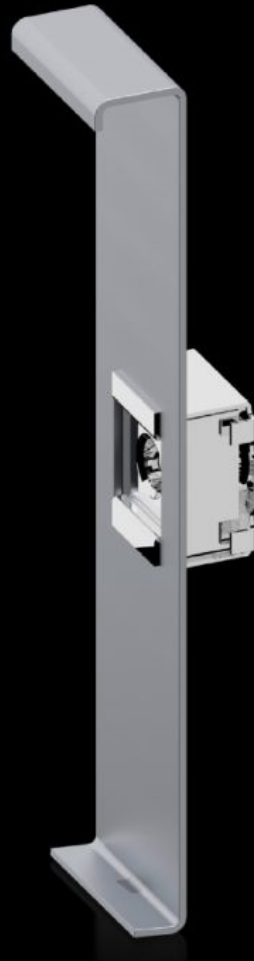

SV 9686.800 Connection set

State: 27.09.2024. (Source: [rittal.com/hr-hr](https://www.rittal.com/hr-hr))

ENCLOSURES

POWER DISTRIBUTION

CLIMATE CONTROL

IT INFRASTRUCTURE

SOFTWARE & SERVICES

FRIEDHELM LOH GROUP



SV 9686.800 - Connection set for Flat-PLS

For assembling top-mounting components or for connecting busbars.

Features

Model No.	SV 9686.800
Product description	For attaching NH slimline fuse-switch disconnectors and NH slimline switch-disconnectors (185 mm) or for connecting busbars. Suitable for busbar system with flat copper 50 x 10 mm
Material	Sheet steel, zinc-plated
Assembly instruction	The connection set may only be used with top-mounting components with screw fastening NH slimline fuse-switch disconnectors: The required screw length when using busbars is 2 x 50 x 10 mm = 35 mm and 4 x 50 x 10 mm = 55 mm
Note	Screws are not included with the supply
Dimensions	Thread: M8
Number of busbars	2 4
Packs of	3 pc(s).
Weight/pack	0,135 kg
Net weight	0.12
Gross weight	0.134
Customs tariff number	39173900
EAN	4028177947276
ETIM 7.0	EC002270
ECLASS 8.0	27409221

Approvals

Explanations

Declaration of conformity

Declaration of conformity UK