



SZ

4000.067



www.rittal.com



1x

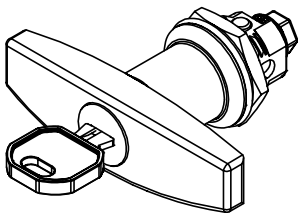

Dok.-Nr. / No of doc.: D-0000-00003162-00

RITTAL GmbH & Co. KG, Auf dem Stuetzelberg, 35745 Herborn
RITTAL Limited, Braithwell Way, Hellaby, Rotherham, S66 8QY, UK

SW10/27



TX30

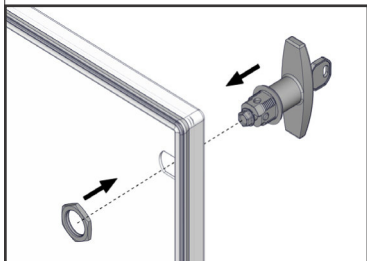
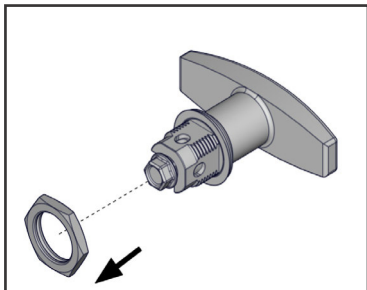
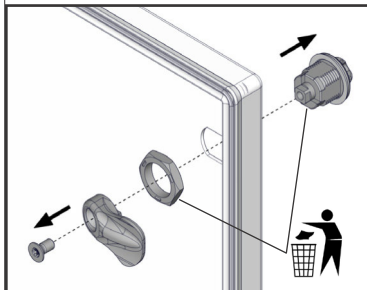

$M_A = 18 \text{ } ^{-0}/_{+2} \text{ Nm}$

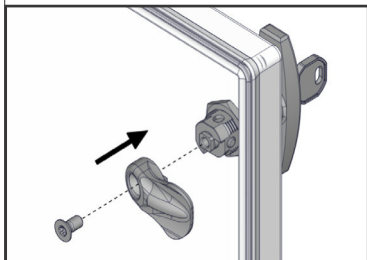
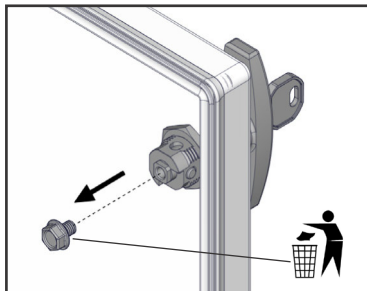

$M_A = 3 \pm 0,5 \text{ Nm}$