

# Schaltschränke

## Standpulte TP

### Standpulte TP

Breite 600/800 mm  
TP 6746.600, TP 6748.600

Breite 1000/1200 mm  
TP 6740.600, TP 6742.600

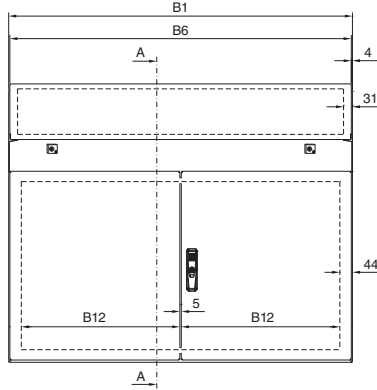
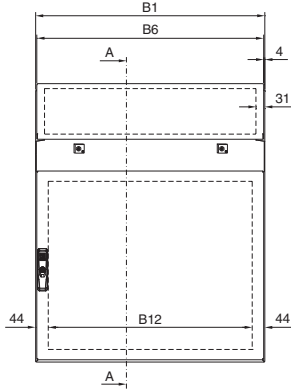

Schnitt A – A

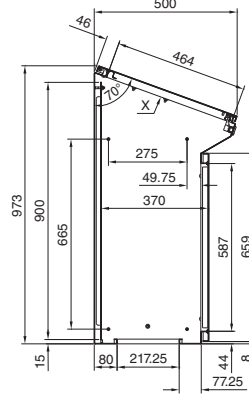

Montageausschnitt

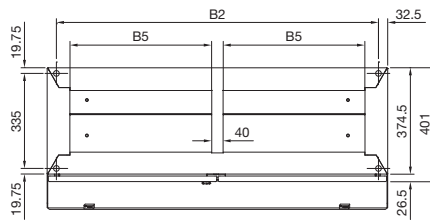
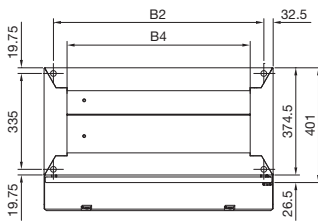
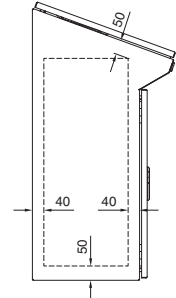

Montageplatte

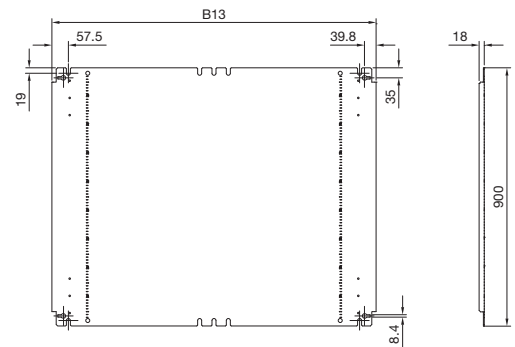

Ansicht in Richtung X

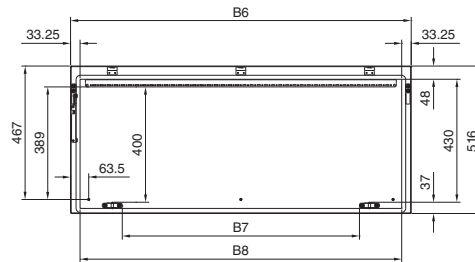

Best.-Nr. TP	Breitenmaße mm								
	B1	B2	B4	B5	B6	B7	B8	B12	B13
6740.600	1000	935	–	400	992	630	925,5	449,5	930
6742.600	1200	1135	–	500	1192	830	1125,5	549,5	1130
6746.600	600	535	440	–	592	230	525,5	712	530
6748.600	800	735	640	–	792	430	725,5	712	730