

Alzate

Larghezza 600/800 mm
TP 6720.500, TP 6721.500

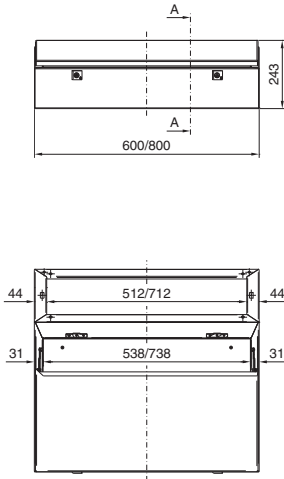

Larghezza 1200/1600 mm
TP 6722.500, TP 6723.500

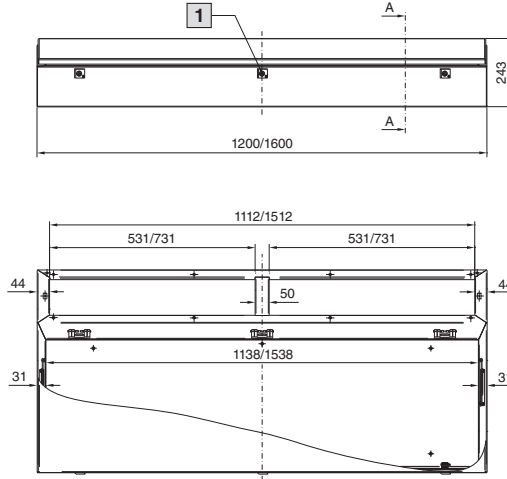

Sezione A - A

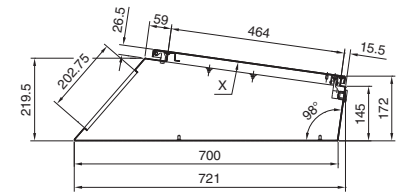

1 Solo con larghezza 1600 mm

Nota:
- Vista X, vedi pagina 2

Leggii, predisposti per il fissaggio dell'alzata

Larghezza 600/800 mm
TP 6714.500, TP 6715.500

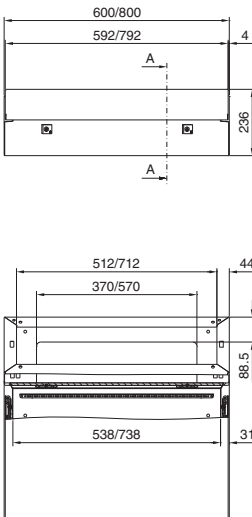

Larghezza 1200/1600 mm
TP 6716.500, TP 6717.500

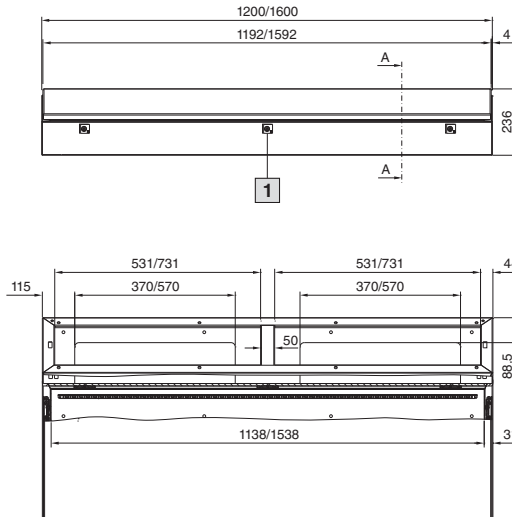

Sezione A - A

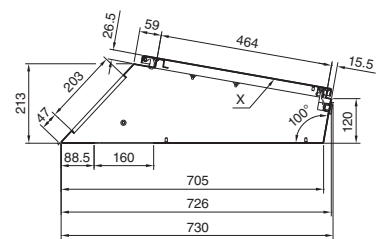

1 Solo con larghezza 1600 mm

Nota:
- Vista X, vedi pagina 2

Armadi di comando

Sistema TopPult TP

Leggii con coperchio incernierato posteriormente

Larghezza 600/800 mm
TP 6710.500, TP 6711.500

Larghezza 1200/1600 mm
TP 6712.500, TP 6713.500

Sezione A – A

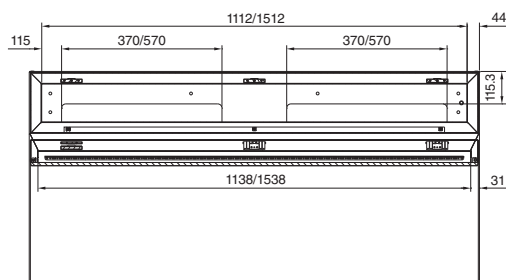
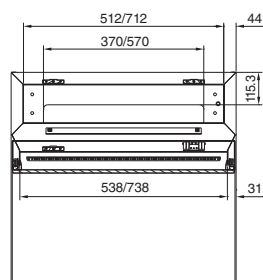
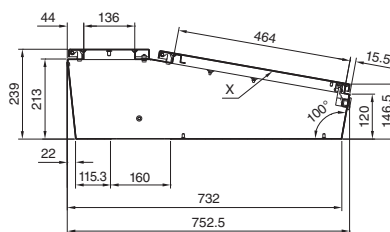
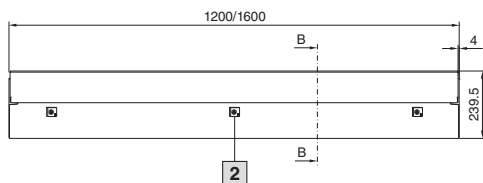
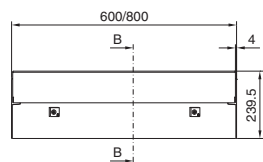

Vista X

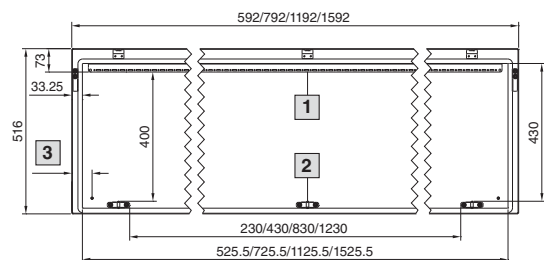

- 1 Non presente con larghezza 600/800 mm
- 2 Solo con larghezza 1600 mm
- 3 Larghezza = 600/800/1200 = 63,5 mm
Larghezza = 1600/163,5 mm

Basamenti, profondità 400 mm

Larghezza 600/800 mm
TP 6700.500, TP 6701.500

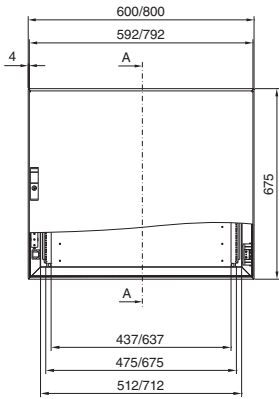

Larghezza 1200/1600 mm
TP 6702.500, TP 6703.500

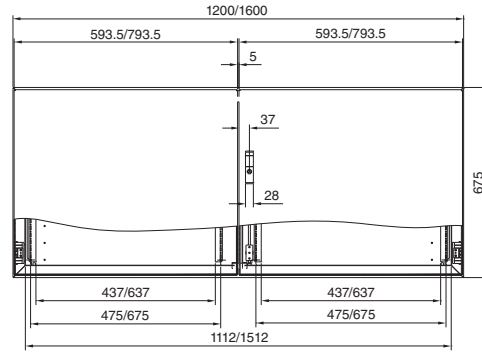

Sezione A - A

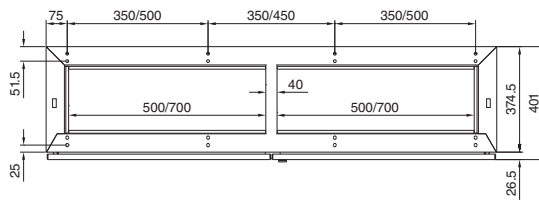
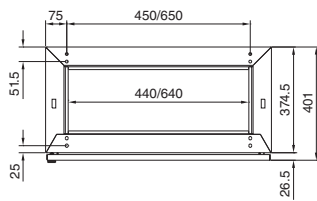
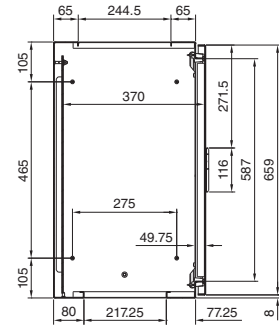

Feritoia di montaggio

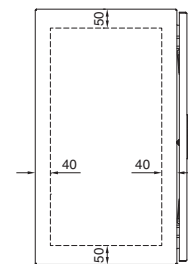

Piastra di montaggio

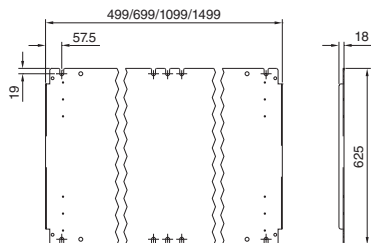

Armadi di comando

Sistema TopPult TP

Basamenti, profondità 500 mm

Larghezza 600/800 mm
TP 6704.500, TP 6705.500

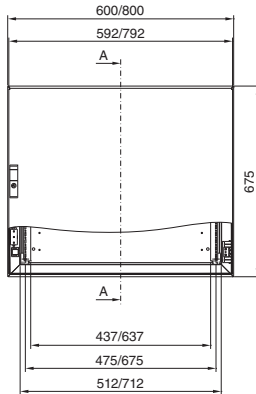

Larghezza 1200/1600 mm
TP 6706.500, TP 6707.500

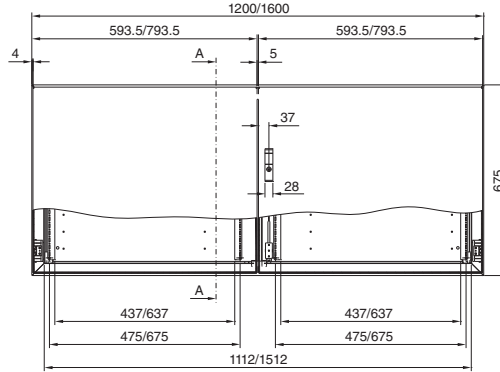

Sezione A - A

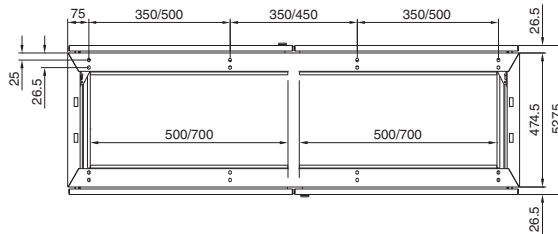
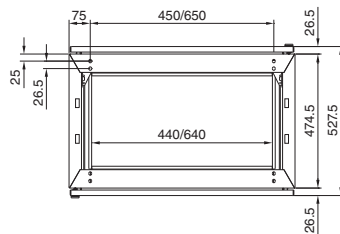
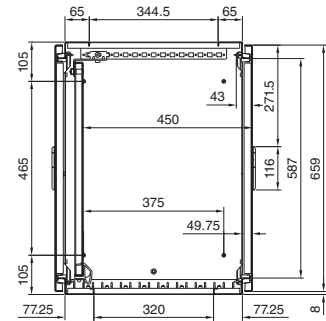

Feritoia di montaggio

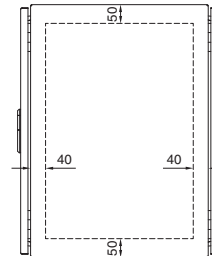

Piastra di montaggio

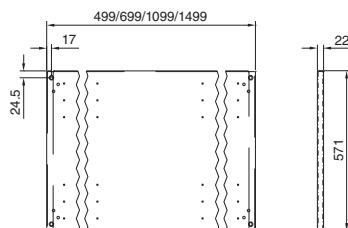

Possibili configurazioni

Struttura in 3 parti

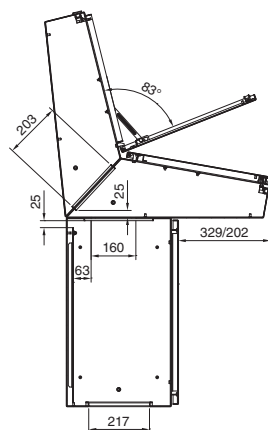
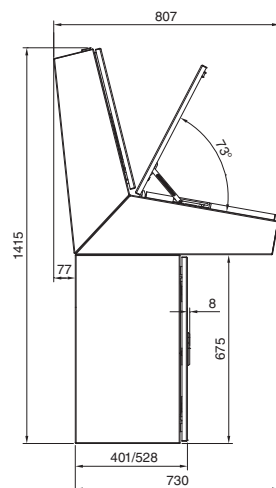

Struttura in 2 parti

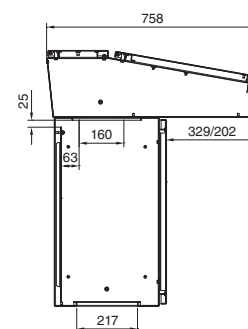
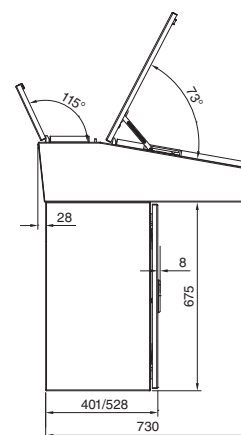

Struttura in 1 parte

