

### Swing frame, large

With trim panel, for 800 mm wide enclosures

Equipment at sides

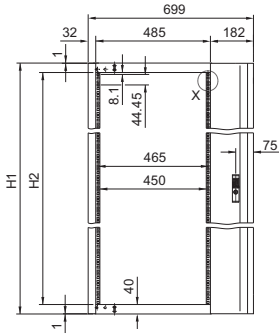

Cut-out "X"

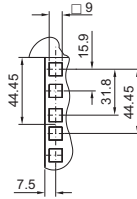

Equipment in centre

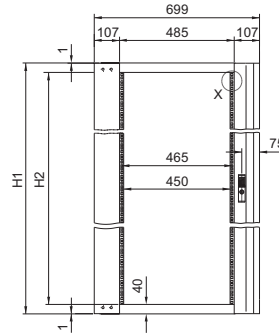

**Note:**

- If the enclosure height is not fully utilised by the swing frame, additional mounting accessories will be required
- For two-door enclosures TS, SE with height 1800 and 2200 mm the next-smallest swing frame must be installed, due to collision with the lock

Height units	22 U		31 U		36 U		40 U		45 U		
	Side	Centre	Side	Centre	Side	Centre	Side	Centre	Side	Centre	
<b>Model No. SR</b>	<b>RAL 7035</b>	<b>2323.235</b>	<b>2324.235</b>	<b>2332.235</b>	-	<b>2337.235</b>	<b>2338.235</b>	<b>2341.235</b>	<b>2342.235</b>	<b>2346.235</b>	<b>2347.235</b>
For enclosure height mm (or higher)	1200		1600		1800		2000		2200		
H1 mm	1061.5		1461.5		1684.5		1861.5		2084.0		
H2 mm	981.5		1381.5		1604.0		1781.5		2004.0		

Installation depth T max. = mm for dimension D<sup>1)</sup> of at least 49 mm with 130° hinge, 95 mm with 180° hinge

Enclosure width mm	800			
Internal mounting	Side		Centre	
Hinge	130°		180°	
Enclosure depth mm	1 T max.		1 T max.	
400	295		252	
500	395		352	
600	470		428	
800	470		428	

<sup>1)</sup> D = Distance from the inner edge of the door to the front edge of the swing frame may be installed deeper on a 25 mm pitch pattern

# System accessories

## 482.6 mm (19") installation system

### 7 examples for TS, SE

#### Full installation

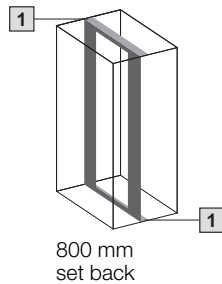
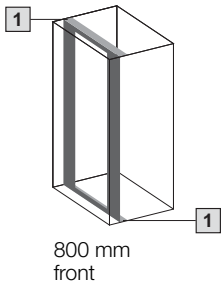

- 1 Installation kit for 800 mm wide enclosures
- 2 TS punched section with mounting flange 23 x 73 mm for the inner level corresponding to the enclosure depth

#### Notes:

- Height compensation between the 25 mm pitch pattern of holes in the enclosure and the height units of the swing frame is achieved by the upper installation kit
- Partial installation at the bottom matches partial installation at the top
- CM only supports full installation at the front

#### Partial installation, top

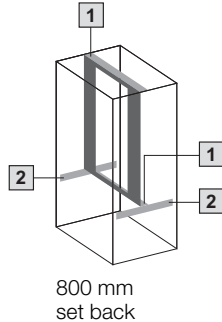
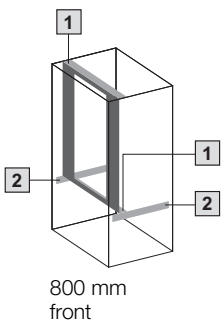

#### Partial installation, centre

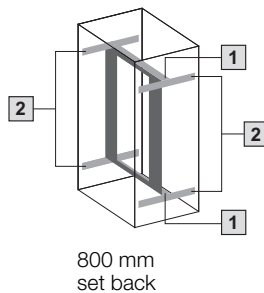
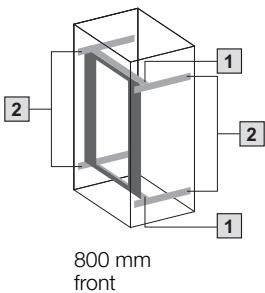

#### Side installation

(for TS only)

With an enclosure depth of 800 mm, side installation of a large swing frame is identical to installation parallel to the front.

For ease of access to the hinges of the swing frame, we recommend the hinges for the TS side panel.

