

Schaltschränke

Standpulte TP

Standpulte TP

Breite 600/800 mm
TP 6746.500, TP 6748.500

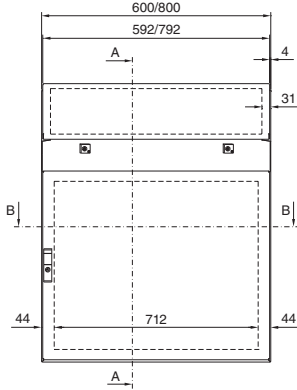

Breite 1000/1200 mm
TP 6740.500, TP 6742.500

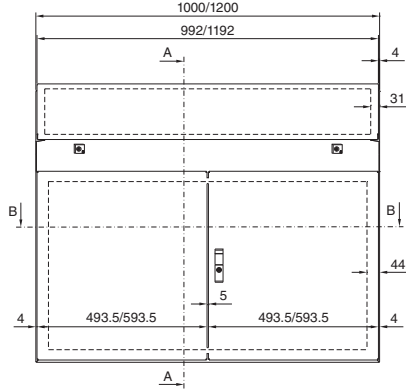

Schnitt A – A

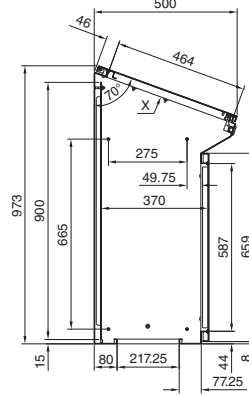

Montageausschnitt

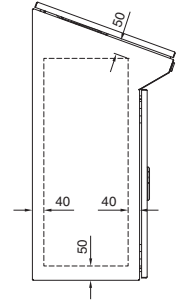

Schnitt B – B

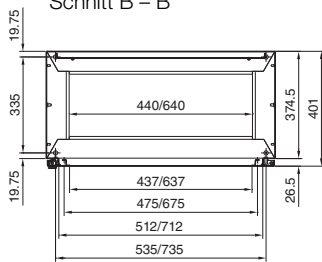

Schnitt B – B

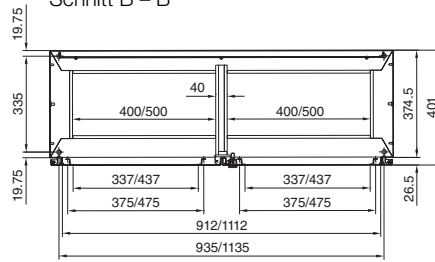

Montageplatte

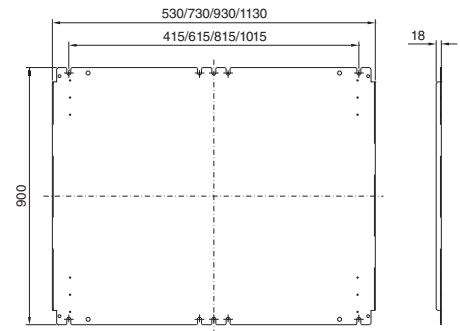

Ansicht in Richtung X

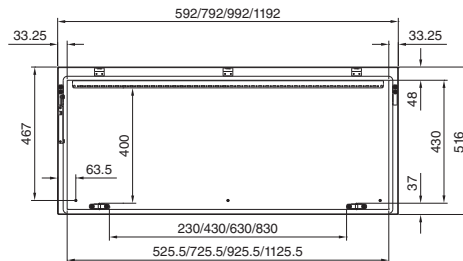

Universalpulte TP

Stahlblech

Mit kurzer Fronttür
TP 2694.500

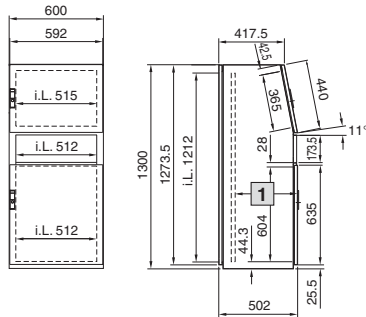

Mit hoher Fronttür
TP 2695.500

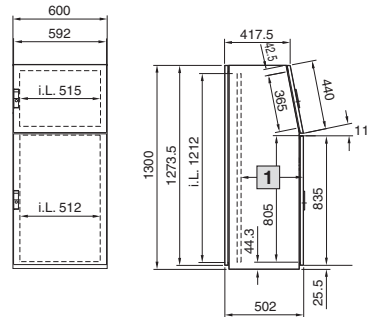

Montageplatte

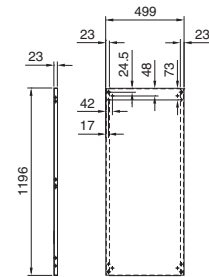

1 Von 200 bis 400 mm im 25 mm-Raster verstellbar