

ISV NH-Lastschaltleisten Leermodul 185mm

SV 9666.550/.560

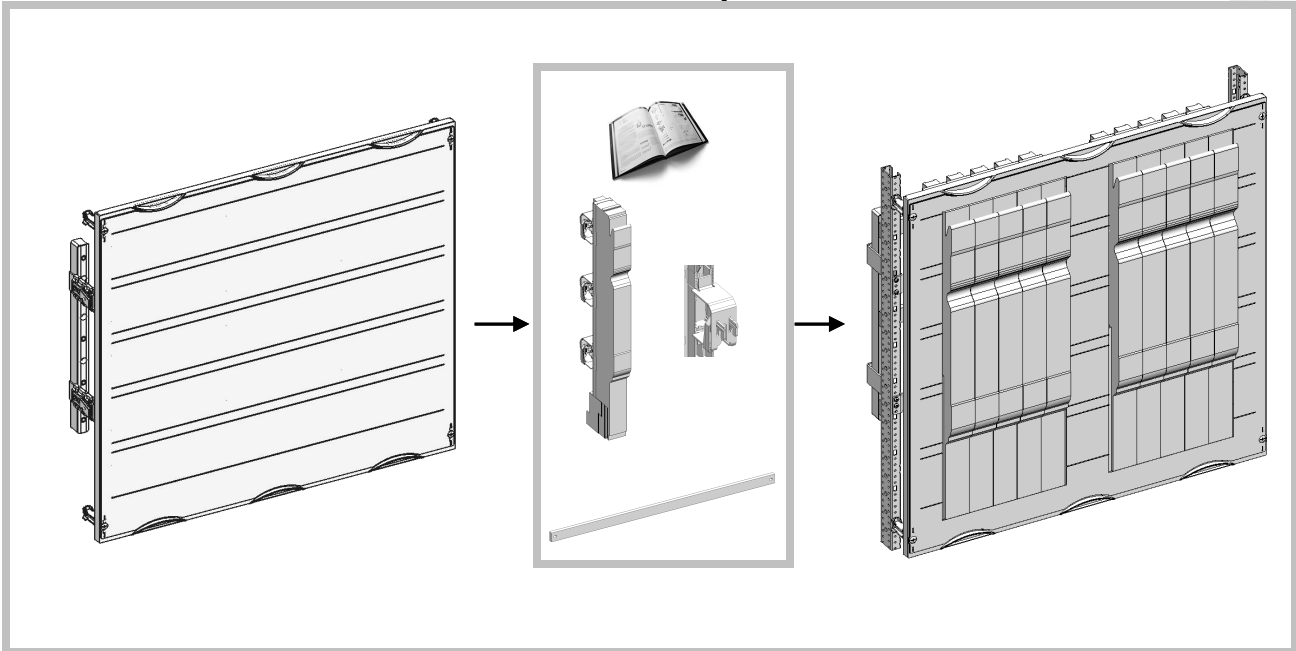

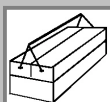



		SV 9666.550	SV 9666.560
1		4 x	4 x
2		4 x	4 x
3		4 x	4 x
4		4 x	4 x
5.1		2 x	2 x
5.2		4 x	4 x
6		1 x	1 x
7		8 x	8 x

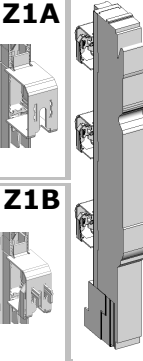
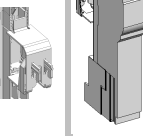

ISV NH-Lastschaltleisten Leermodul 185mm

SV 9666.550/.560



		SV 9666.550	SV 9666.560
Z1A 	SV 9346.040 SV 9346.050	8 x	12 x
	SV 9346.110 SV 9346.210 SV 9346.310	4 x	6 x
Z1B 	SV 9346.040 + 9346.470 SV 9346.050 + 9346.470	8 x	12 x
	SV 9346.110 + 9346.440 SV 9346.210 + 9346.440 SV 9346.310 + 9346.440	4 x	6 x
CU1	 40x10 50x10 60x10	3 x	3 x
Z2	 M8x25 (DIN EN 24017)	6 x	6 x
Z3	 M8 (DIN 6796)	6 x	6 x

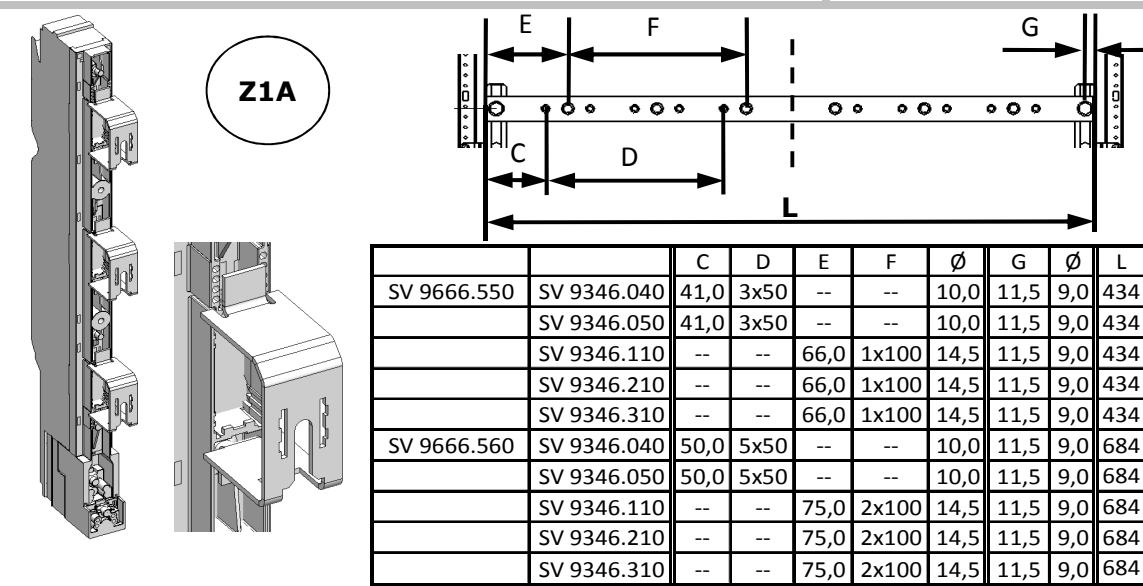
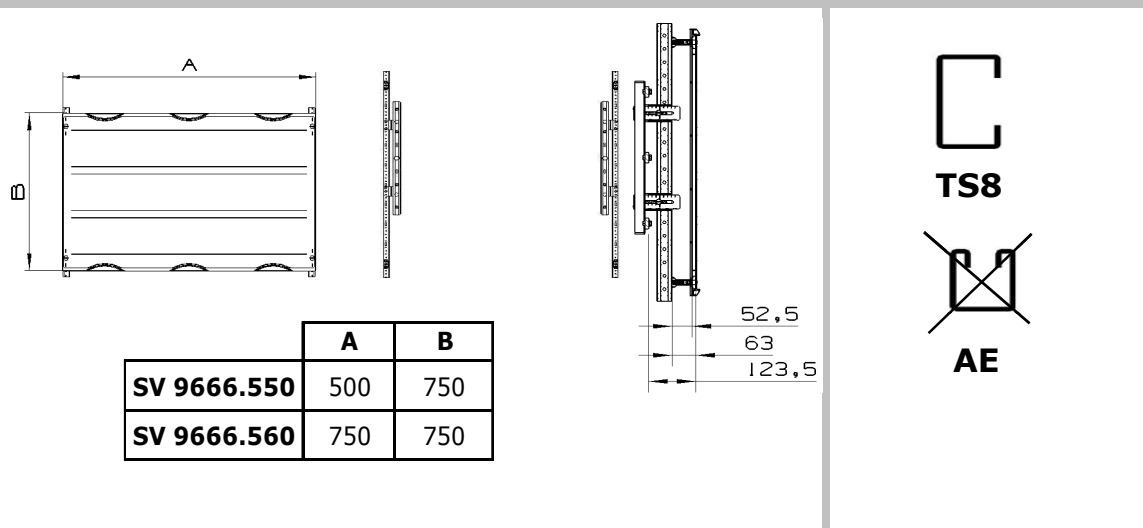

ISV NH-Lastschaltleisten Leermodul 185mm

SV 9666.550/.560



1 4x

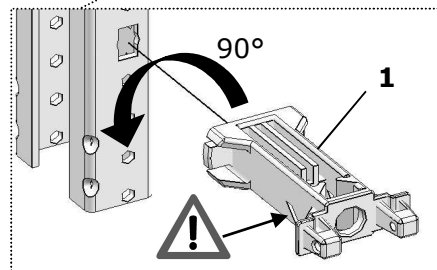
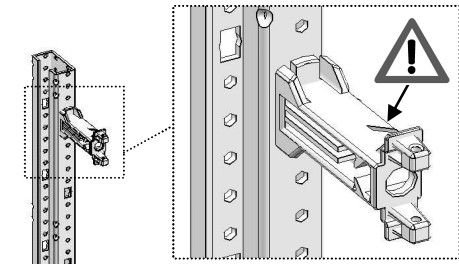
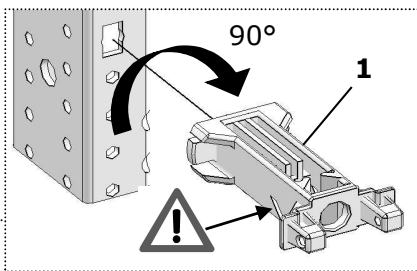
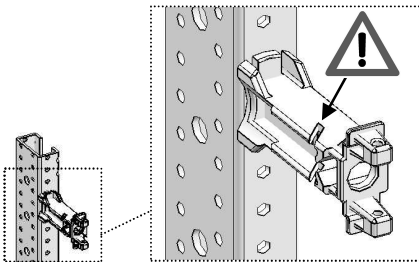

1

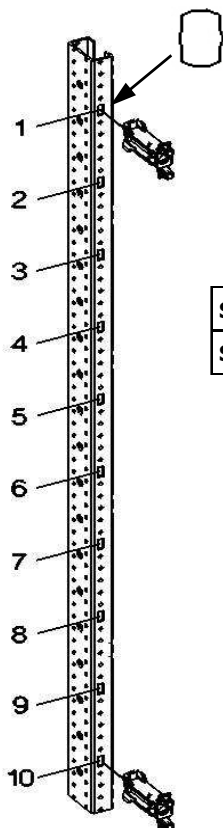

SV 9666.550	2/5	1&10
SV 9666.560	3/5	1&10

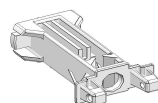
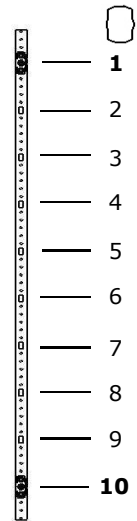
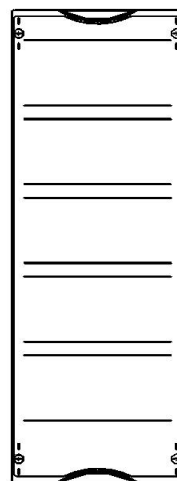

→ **SV 9666.550** → 2/5 = **1 & 10**

1.1

ISV NH-Lastschaltleisten Leermodul 185mm

SV 966.550/.560



2 4x	7 8x 4,8x9,5	T25 4Nm
-------------	------------------------	----------------

Positionen der Winkel stimmen nicht

3 4x M6x20	4 4x D 6,4	5.2 4x	SW5 5Nm
----------------------	----------------------	---------------	----------------

5.1 2x

Richtige Position der Winkel

ISV NH-Lastschaltleisten Leermodul 185mm

SV 9666.550/.560



Z3 6x
D 8,4

Z2 6x
M8x25

CU1 3x

SW13 10Nm

	G
SV 9666.550	185
SV 9666.560	185

4

Z1A 4-12x

Z1B 4-12x

SV 9666.550	SV 9346.040	27,0	404,0	0,0	0,0
	SV 9346.050	27,0	404,0	0,0	0,0
	SV 9346.110	27,5	403,0	0,0	0,0
	SV 9346.210	27,5	403,0	0,0	0,0
	SV 9346.310	27,5	403,0	0,0	0,0
SV 9666.560	SV 9346.040	36,5	302,5	30,0	302,5
	SV 9346.050	36,5	302,5	30,0	302,5
	SV 9346.110	37,0	302,0	30,0	302,0
	SV 9346.210	37,0	302,0	30,0	302,0
	SV 9346.310	37,0	302,0	30,0	302,0

5

ISV NH-Lastschaltleisten Leermodul 185mm

SV 9666.550/.560



6 1x

6

+ PH2

	Z1A	A (Z1A)	Z1B	A (Z1B) CU 40mm	A (Z1B) CU 50mm	A (Z1B) CU 60mm	B	C	D	E	F
SV 9666.550	SV 9346.040	34,5	SV 9346.040 + SV 9346.470	54,5	59,5	64,5	642,0	48,0	404,0	--	--
	SV 9346.050	34,5	SV 9346.050 + SV 9346.470	54,5	59,5	64,5	642,0	48,0	404,0	--	--
	SV 9346.110	34,5	SV 9346.110 + SV 9346.470	54,5	59,5	64,5	642,0	48,5	403,0	--	--
	SV 9346.210	34,5	SV 9346.210 + SV 9346.470	54,5	59,5	64,5	642,0	48,5	403,0	--	--
	SV 9346.310	34,5	SV 9346.310 + SV 9346.470	54,5	59,5	64,5	642,0	48,5	403,0	--	--
SV 9666.560	SV 9346.040	34,5	SV 9346.040 + SV 9346.470	54,5	59,5	64,5	642,0	57,5	302,5	30,0	302,5
	SV 9346.050	34,5	SV 9346.050 + SV 9346.470	54,5	59,5	64,5	642,0	57,5	302,5	30,0	302,5
	SV 9346.110	34,5	SV 9346.110 + SV 9346.440	54,5	59,5	64,5	642,0	58,0	302,0	30,0	302,0
	SV 9346.210	34,5	SV 9346.210 + SV 9346.470	54,5	59,5	64,5	642,0	58,0	302,0	30,0	302,0
	SV 9346.310	34,5	SV 9346.310 + SV 9346.470	54,5	59,5	64,5	642,0	58,0	302,0	30,0	302,0

- DE** Arbeiten an elektrischen Betriebsmitteln/Anlagen dürfen nur durch eine ausgebildete Elektrofachkraft gemäß DIN 57105 Teil 1 / VDE 0105 Teil 1 / DIN EN 50110-1 durchgeführt werden.
- GB** Only qualified electrical personell according to DIN 57105 part 1 / VDE 0105 part 1 / DIN EN 50110-1 are allowed to work on electrical installations.
- ES** Sólo electricistas cualificados según norma DIN 57105 part 1 / VDE 0105 part 1 / DIN EN 50110-1 están autorizados a trabajar en instalaciones.
- RU** Согласно DIN 57105, часть 1 / VDE0105, часть 1 / DIN EN 50110-1, на электрических установках разрешается работать только квалифицированному персоналу.

RITTAL GmbH & Co. KG
 Postfach 1662 • D-35726 Herborn
 Phone +49(0)2772 505-0 • Fax +49(0)2772 505-2319
 E-Mail: info@rittal.de • www.rittal.de

EDV.-Nr.: 118473 / 1
 01/12
 printed in Germany

SCHALTSCHRÄNKE STROMVERTEILUNG KLIMATISIERUNG IT-INFRASTRUKTUR SOFTWARE & SERVICE



FRIEDHELM LOH GROUP